



# Get Started!



Discover our full  
training course online



## What you have

# Teach & Treat Remote Reward Trainer

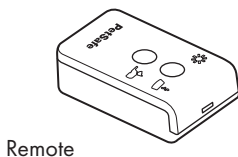
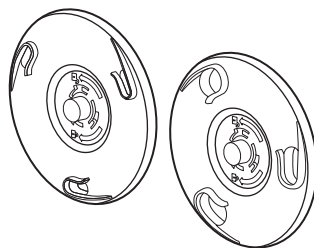
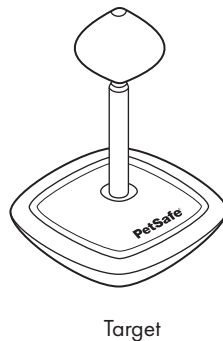
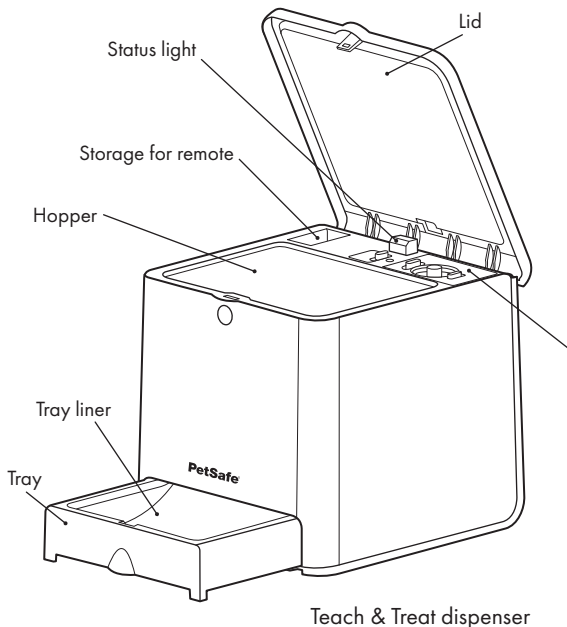

3V Lithium CR2032 batteries

## What you need

- 4 D-cell alkaline batteries
- Dry or semi-moist treats or kibble
- Phillips (cross head) screwdriver

## How it works

The Teach & Treat is a reward system that reinforces good behavior by remotely dispensing dry treats/kibble at the push of a button. It can be used with or without an audible tone and also has a Fixed/Variable setting for the treats/kibble. The system is very effective in stopping problem behaviors such as begging and jumping on guests and teaching calm behaviors such as Down/Stay.

## Nutritionally balanced diet for your dog

It is important that your dog is already on a nutritionally balanced feeding program before you begin using the Teach & Treat. If you are using dry dog food/kibble, ensure it is the correct size and can be used in the Teach & Treat for training.

**Note:** If you free feed your dog and he shows no interest in the kibble from the Teach & Treat, change to specific meal feeding times during the day while training with the Teach & Treat. This should make the dispensed kibble more enticing. If you use treats instead of kibble, your training sessions should be extended over a longer period, and the total calorie intake should be subtracted from your dog's daily intake of food. For most dogs, treats should make up less than 10% of a dog's daily food intake.

## 1 Install the batteries

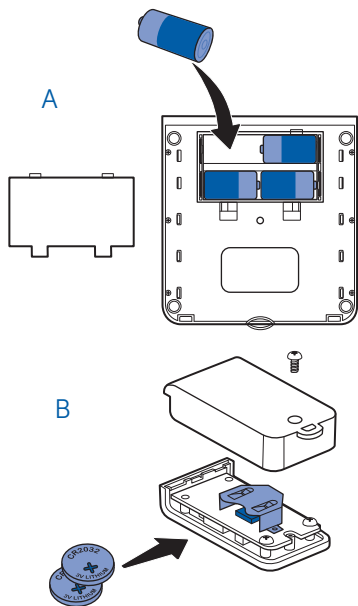

- A. Remove the battery door on the bottom of the dispenser and insert 4 D-cell alkaline batteries (not included). Replace the battery door.
- B. Remove the screw securing the battery cover to the back of the remote. Insert two 3V Lithium CR2032 batteries (provided). Replace the battery cover. The LED on the remote glows when you press a button: green when the batteries are good, and red when batteries are low.

## 2 Load treats or kibble

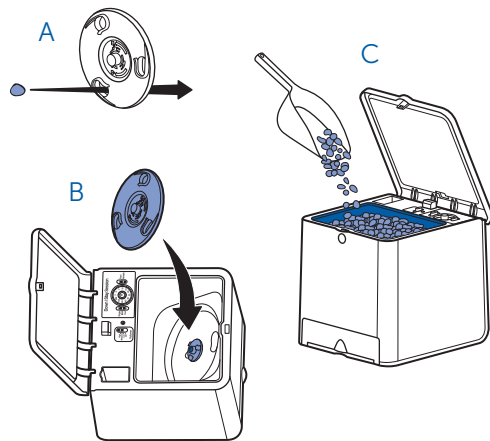



We recommend you wash and rinse the tray liner and the treat/kibble discs before use. Once the parts are dry, replace the tray liner and continue setup:

- A. Select the kibble disc that best fits the dry or semi-moist kibble or treat you will be using. (Oval or round treats/kibble of uniform size work best.)
- B. Place the selected disc onto the dispensing mechanism in the hopper and turn it clockwise to lock it in place.
- C. Add 1-2 cups of your dog's favorite dry or semi-moist treats/kibble to the hopper. If using your dog's regular meal for training, place one meal's worth of food in the hopper.

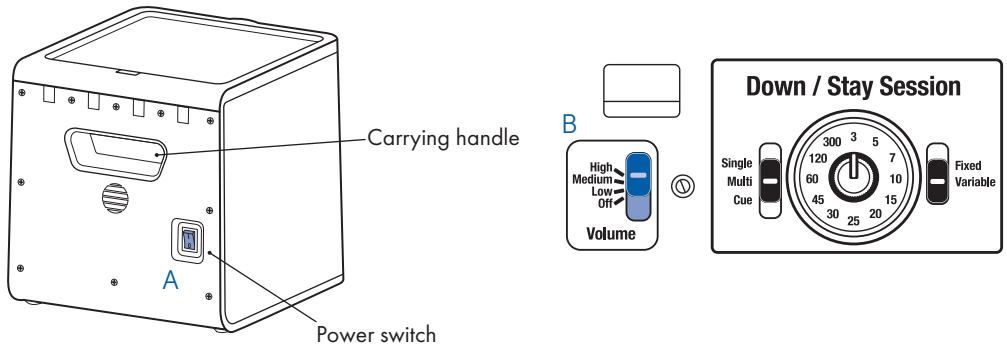
### 3 Turn on and test the dispenser





For best results, perform these steps away from your dog:

- A. Press the power switch on the back of the dispenser to turn the unit on (I). The status light will glow green.
- B. If your dog is in the room with you, open the lid and set the Volume switch to Off. It is best to let your dog get used to the sound of the dispenser before adding a tone.
- C. Press the dispense button  on the remote to dispense the food. You may need to press the button a few times to get the treats/kibble to dispense after filling.
- D. Once the treats/kibble start dispensing, press the dispense button  several more times to make sure the food size is compatible with the disc you selected. If the food size is correct, a treat/kibble should dispense each time you press the dispense button . Jamming will occur if the treats/kibble are too large or moist.

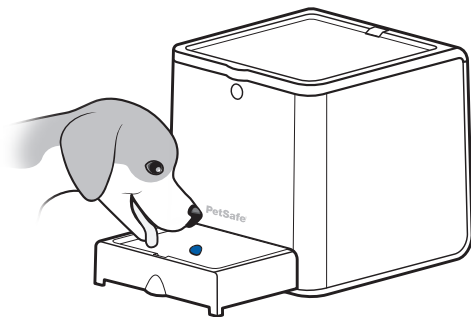
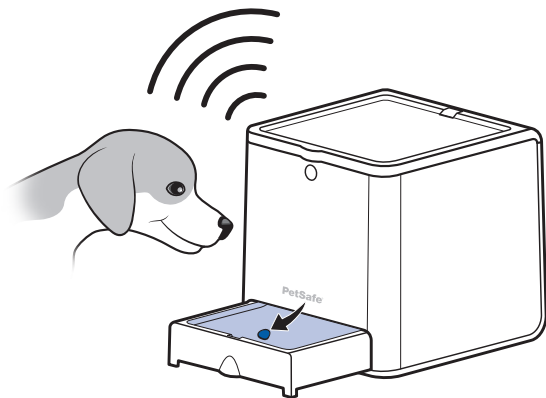
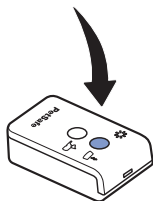
## 4 Introduce your dog to the Teach & Treat



The Teach & Treat includes an audible tone that can be used to help introduce your dog to the system, as well as additional training. Using the remote and treat dispenser, spend 10-15 minutes a day for a few days to teach your dog the association. Most dogs quickly learn a treat follows the tone.

- A. Before teaching your dog the tone, set the Volume switch to Off.
- B. Place treats/kibble by hand in front of the treat dispenser. After your dog eats them, repeat adding more treats/kibble.
- C. If your dog is comfortable with the treat dispenser, press the dispense button  on the remote to dispense the treats/kibble. Continue until your dog is comfortable taking the food from the dispenser.
- D. Move the Volume switch to Low. Press the dispense button  on the remote to dispense treats/kibble. Repeat 6-8 times. Your dog will learn the treats follow the tone.
- E. Some dogs become very attentive to the dispenser, however they must also learn who is controlling the treat dispensing. If your dog automatically looks at you for reassurance between treats or because he knows who is controlling the treat dispensing, you are ready to move on to additional training. Ensure you reward him each time he looks to you by toning and treating. If your dog has not learned you are controlling the treats, get his attention by calling his name and when he looks, press the dispense button  on the remote to tone and treat. Repeat until your dog is consistent.

**Note:** To ensure your dog has learned the tone/treat association, practice in different locations and add distance. Repeat until your dog consistently responds to the tone from 8-10 feet away.

## 5 Train for success

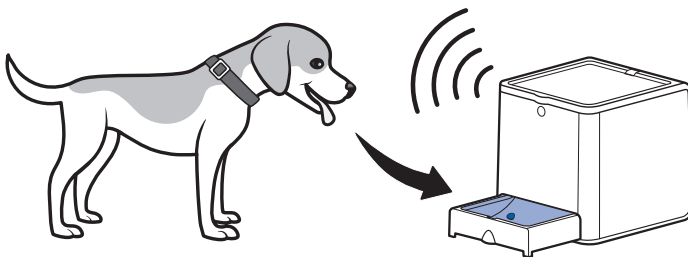

Successful training is not only about eliminating unwanted behaviors but replacing those behaviors with routines that are safe and easy to learn for you and your pet. The Teach & Treat is designed specifically to create new, positive habits in response to the most common household dilemmas. With the ability to reward your pet in a separate location, you're unlocking the potential for good behavior in the entire home—not just by your side.

For training to be successful you should spend at least 10-15 minutes per day over a 2-week period training. The Teach & Treat is very versatile and can be used to improve many behaviors.

Start your first training lesson on [petsafe.com](https://petsafe.com).

### General training tips:

- For multi-dog households, train one dog at a time.
- Use only dry or semi-moist treats/kibble that fit in the small or large disc.
- When using the remote, it is best that your dog associates the treats/kibble with you, not the remote. Don't point the remote at your pet.
- Keep training fun! Begin training with his favorite treats/kibble until your dog is comfortable taking food from the dispenser.
- If your dog barks, tries to bite or paw at the Teach & Treat, change his focus to you. Give him treats from your hand before using the Teach & Treat. As he quiets and gives you good behavior, give a treat from the Teach & Treat.
- Make sure your dog is motivated to work for the treats/kibble before starting to train.



## 6 Control Panel

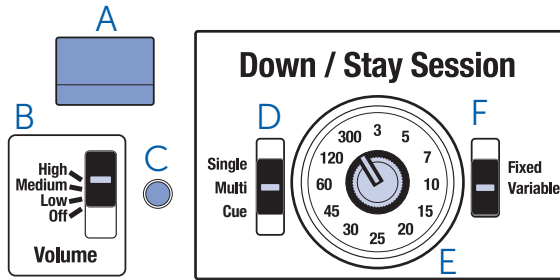

The control panel includes basic controls and more advanced Down/Stay Session controls you will use as you progress further into training.

- A. Status light:** Illuminates to provide Teach & Treat status:
- Solid green: The dispenser is on, and the batteries are good.
  - Solid blue: The dispenser is in Down/Stay mode.
  - Solid red (button press displays green for 1 sec): Battery power is low; replace the batteries.
  - Fast flashing red (with tone): The dispenser is jammed.
  - Fast flashing yellow (with tone): The dispenser is empty.
- B. Volume switch:** Controls the volume of the tone when treats are dispensed.
- C. Pairing button:** Used to pair the remote with the dispenser if pairing is lost.
- D. Treat setting switch:**
- Single: Dispenses one treat at a time.
  - Multiple: Dispenses 3 treats in succession (depending on treat size).
  - Cue: Beeps to alert you when to dispense treats. When this setting is selected, the timer will beep but the treat will not be dispensed until you press the dispense  button on the remote.
- E. Treat rate dial:** Determines treat frequency (in seconds) when training the down/stay.
- F. Fixed/Variable switch:**
- Fixed: Dispenses treats/kibble at the exact frequency selected on the treat rate dial.
  - Variable: Dispenses treats at an unpredictable interval averaging the frequency selected on the treat rate dial.

## 7 Frequently asked questions & troubleshooting

### **What if my dog is afraid of the Teach & Treat?**

Begin by giving treats from your hand. After providing a few treats/kibble, make a trail of treats/kibble leading to the Teach & Treat. Do not dispense any treats but allow your dog to walk up to the Teach & Treat. After repeating this several times, your dog will learn to walk up to the Teach & Treat without hesitation.

### **My dog is barking or pawing at the dispenser.**

If your dog barks or paws at the Teach & Treat, his attention needs to be refocused on you. Do not dispense any treats/kibble if your dog is barking or pawing at the dispenser. When your dog is quiet or not pawing, give him a treat/kibble from your hand. Repeat, giving him a treat/kibble from your hand several times until he is quiet or not pawing. Gradually increase the interval between treats/kibble, this will extend the time of not pawing and not barking. Once he consistently waits for his treats/kibble, begin treating him from the Teach & Treat.

### **My Teach & Treat is dispensing slowly.**

Ensure the treats/kibble are the correct size for the disc.

### What is the range?

The Teach & Treat works up to 30 feet.

### My Teach & Treat is not dispensing when I press the dispense button .

Make sure the Teach & Treat power switch is in the on (I) position. Check the indicator light on the dispenser. If it is flashing red, the batteries are low; replace the batteries. Check the batteries in the remote and replace if necessary. If your Teach & Treat still does not respond, the remote may have become unpaired from the dispenser. To pair the remote with the dispenser, press and hold the pairing button for 3 seconds. The status light will flash green to show that the dispenser is in pairing mode. Press any button on the remote. The status light should glow solid green to show the remote and the dispenser are now paired.

### How do I clean the Teach & Treat?

Remove all batteries from the Teach & Treat and then wipe it down with a damp cloth. You can remove the tray liner and discs and wash them by hand or in the dishwasher. **Important:** Do not disassemble the Teach & Treat except for the tray liner and treat/kibble discs. Do not use any kind of spray chemicals or solvent to clean. Do not immerse the dispenser in water or any other liquid.

# Teach & Treat

## Remote Reward Trainer



Discover our full  
training course online



**We're here to help!**

For questions or additional tips:

+1 (800) 732-2677

[petsafe.com](https://petsafe.com)

1-Year Warranty | ©2022 Radio Systems Corporation | Model: PDT00-17709 | L400-2572/1

For important safety information, please see the customer care guide.